

SLML^N / SLMIN

120lm/W

LED

- LED und GU10 Schienenstrahler
- Grundkörper aus lackiertem Alu-Druckguss
- LED oder Fassung GU10 (nur für LED Leuchtmittel geeignet)
- LED Version Ausstrahlwinkel 20° und 40°
- Dreh- und schwenkbar
- Schutzart: IP20
- Schutzklasse: I

- LED and GU10 power-track-spotlight
- Body in coated die-cast aluminium
- LED or socket GU10 (only suitable for LED lamps)
- Beam angle LED version 20° and 40°
- Rotatable and swiveling
- Protection Rating: IP20
- Protection Class: I



GU10



GU10

LED

3-Phasen-Adapter | 3-phase-adaptor



SLML-12 | 220-240 V | LED | CRI 90



∠ 20°	□	■	12 W
4000 K	SLML-12NW11	SLML-12NW12	1553 lm
3500 K	SLML-12WNW11	SLML-12WNW12	1537 lm
3000 K	SLML-12WW11	SLML-12WW12	1522 lm
2700 K	SLML-12SW11	SLML-12SW12	1491 lm

∠ 40°	□	■	12 W
4000 K	SLML-12NW11F	SLML-12NW12F	1663 lm
3500 K	SLML-12WNW11F	SLML-12WNW12F	1646 lm
3000 K	SLML-12WW11F	SLML-12WW12F	1630 lm
2700 K	SLML-12SW11F	SLML-12SW12F	1597 lm

Ausführung DALI ONETRACK | Version DALI ONETRACK

Code + **DDO** (**SLML-12NW11DDO**)

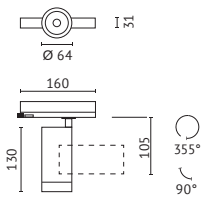

120lm/W



SLML-16 | 220-240 V | LED | CRI 90



∠ 20°	□	■	16 W
4000 K	SLML-16NW11	SLML-16NW12	1979 lm
3500 K	SLML-16WNW11	SLML-16WNW12	1959 lm
3000 K	SLML-16WW11	SLML-16WW12	1940 lm
2700 K	SLML-16SW11	SLML-16SW12	1892 lm

∠ 40°	□	■	16 W
4000 K	SLML-16NW11F	SLML-16NW12F	2133 lm
3500 K	SLML-16WNW11F	SLML-16WNW12F	2111 lm
3000 K	SLML-16WW11F	SLML-16WW12F	2091 lm
2700 K	SLML-16SW11F	SLML-16SW12F	2049 lm

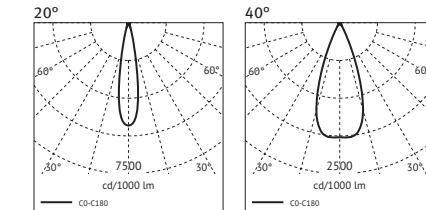

GU10

3-Phasen-Adapter | 3-phase-adaptor



SLMN | 230V GU10 (max. 7 W)



1x GU10
Ø64 x H145 mm

SLMN-10011 **SLMN-10012**

Lieferung ohne Leuchtmittel
Delivery without illuminant

Leuchtmittel | Lamp
QPAP 51 max. 7 W/230V GU10

LVK ist abhängig vom
verwendeten Leuchtmittel
IDC depends on the used lamp

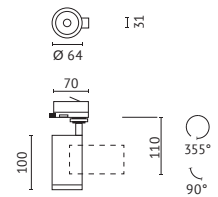

Farben | Colors

□ Weiß | White ■ Schwarz | Black